

ADDITIONAL INFORMATION

Tender Iziko South African Museum Shop and Café

1. BACK GROUND AND INTRODUCTION

Iziko Museums of South Africa (Iziko) is a public entity subsidised by the national Department of Arts and Culture bringing together 12 national museums situated in the Western Cape under a single governance and leadership structure. The 12 museums each have its own history and character (see www.iziko.org.za).

Iziko is an isiXhosa word, meaning ‘hearth’ – traditionally and symbolically the social centre of the home; a place associated with warmth, kinship and ancestral spirits. Here food is prepared and shared, stories are told and knowledge passed from one generation to the next. Similarly, the museums that make up Iziko are spaces for cultural interaction. We are proud to ignite connections between our shared history, our heritage, and one another.

Iziko requires a service provider to run an innovative and brand appropriate hospitality and retail service at one of our flagship museum’s - the Iziko South African Museum and Planetarium located in the Company Gardens just off Queen Victoria Street in central Cape Town.

2. OVERVIEW

Location: Iziko South African Museum Café and Shop
Iziko South African Museum and Planetarium
25 Queen Victoria Street
Cape Town

Trading Hours: Daily 10:00 to 17:00 (closed on Workers Day and Christmas Day)

The designated area (see 2.1) is resourced with all necessary basic infrastructures to facilitate the required service (see 2.2).

Operators will however have to provide all additional equipment for operational necessities such as a Point of Sale System (POS); coffee machine; crockery; cutlery etc. as well items that may add ambience e.g. sofas and/ or other décor items. (see 2.3)

2.1. Space available/ specification

The designated area is approximately, one hundred and two metre squared (102 m²)
(plus limited space for additional tables in the area referred to as the Gathering Space see below)

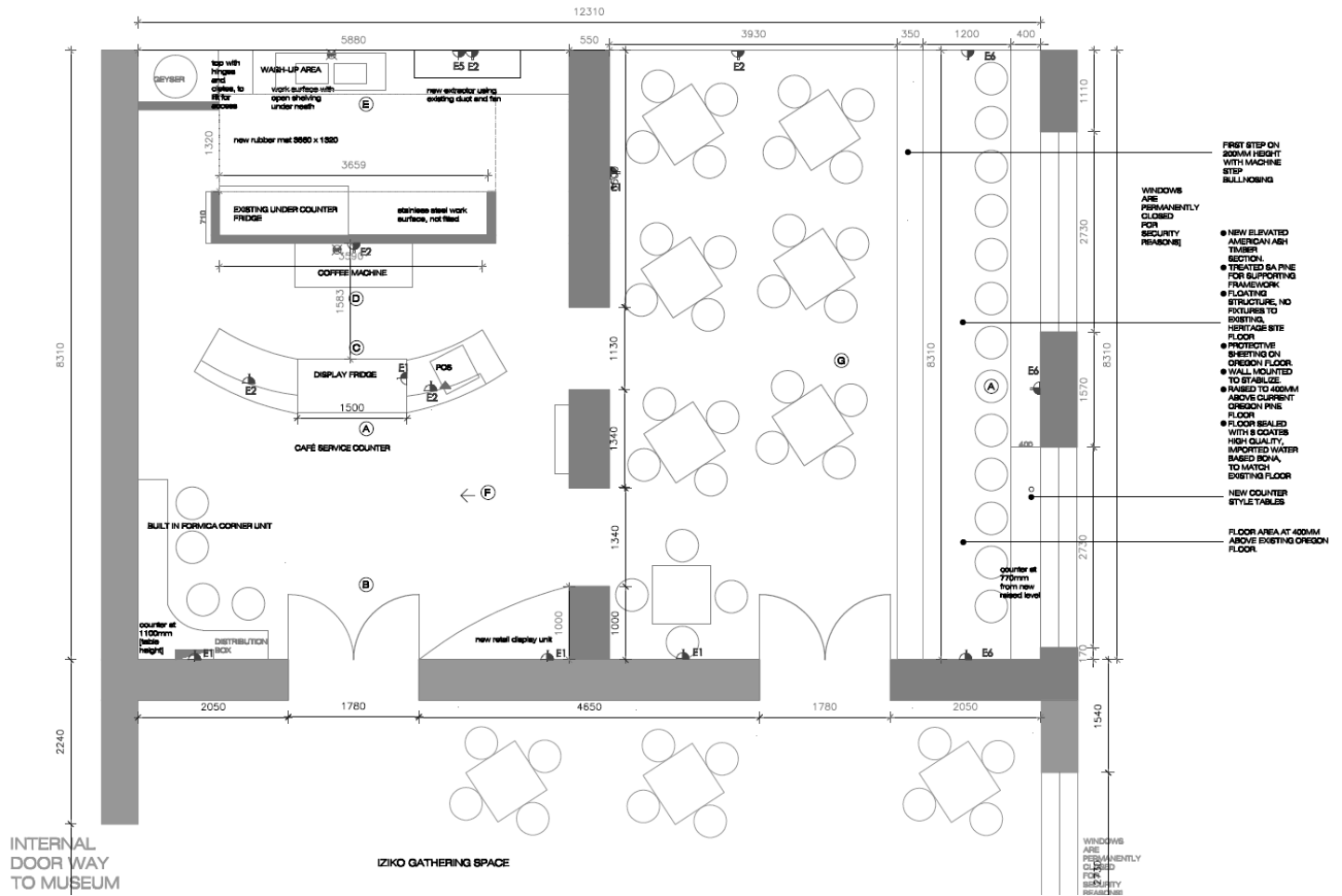

2.2. The following items are provided

FURNITURE:

- service counter;
- cabinet for the coffee machine;
- kitchen cabinets as per plan;
- counters;
- 16 x 800 x 800cm tables with bases;
- 4 counter chairs;
- 53 chairs;
- 2 black boards with frames and metalwork preparation table in kitchen.

EQUIPMENT

- deli display fridge;
- fridge for kitchen;
- extractor fan for kitchen.

PLUMBING AND PLUMBING FITTINGS

Plumbing for the kitchen includes: 1500mm double sink with waste; sink mixer; combination sink trap and angle valve for coffee machine.

All the necessary electrical fittings have been installed.

2.3. The following items need to be provided by the service provider

- commercial coffee machine with three groupheads, commercial coffee grinder;
- any other equipment required to effectively perform the function;
- Point of Sale System (POS) – as per Iziko specification;
- cutlery and crockery;
- menu's – to be developed in discussion with and approved by Iziko Management;
- signage – to be developed in discussion with and approved by Iziko Management;
- and any other items necessary to facilitate the effective operation of the space to be approval by Iziko.